

abbotFox



Norwich, NR3

Offers In Excess Of £300,000

“

We are a team of genuine individuals who hold a deep passion for both property and marketing. Collectively, we bring over 70 years of experience in the property market of Norfolk and Suffolk. Our affection for both counties runs deep, and we are enthusiastic about sharing our passion with you.

Colin McKenzie | **Branch Partner**



THE DETAIL _____

abbotFox presents this ideal investment opportunity. Occupying a secluded position overlooking the nearby park, this three storey townhouse has been successfully let, and is being offered to the market as a going concern. Accommodation is spread over three floors, and provides a high degree of flexibility in its layout, with the property also benefitting from a private enclosed rear garden, parking and garage. Situated within easy reach of a variety of local amenities, an internal viewing comes highly recommended.

THE HIGHLIGHTS _____

- Three storey townhouse
- Three / four bedrooms
- Flexible layout
- Private garden
- Parking and garage
- Investment opportunity
- Let at £2,400 pcm

GROUND FLOOR
35.9 sq.m. (386 sq.ft.) approx.

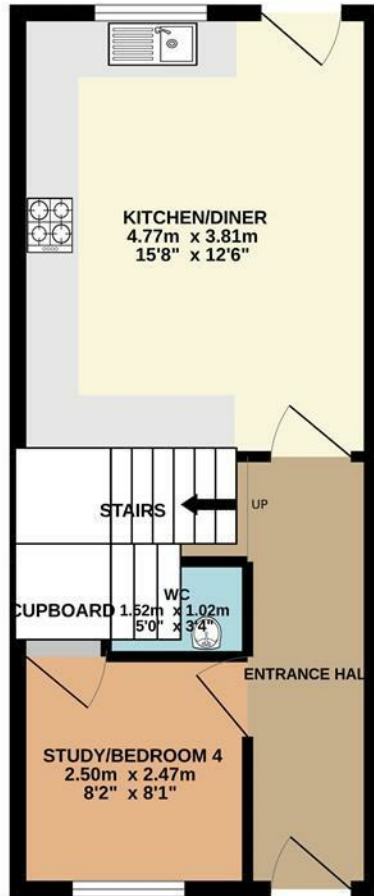

1ST FLOOR
35.9 sq.m. (386 sq.ft.) approx.

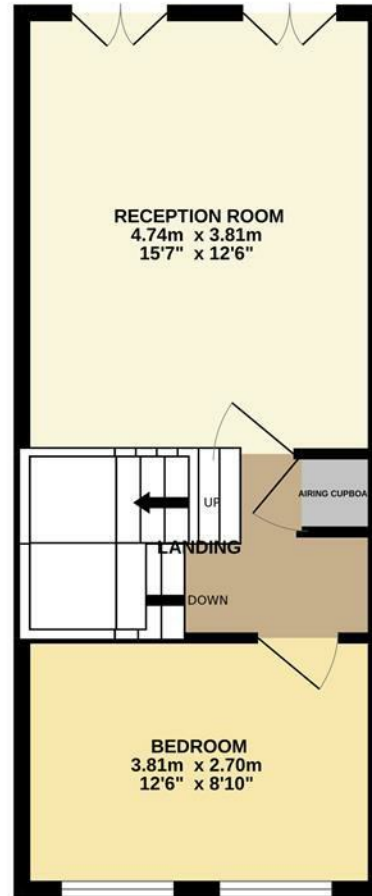

2ND FLOOR
35.9 sq.m. (386 sq.ft.) approx.



TOTAL FLOOR AREA : 107.7 sq.m. (1159 sq.ft.) approx.

Whilst every attempt has been made to ensure the accuracy of the floorplan contained here, measurements of doors, windows, rooms and any other items are approximate and no responsibility is taken for any error, omission or mis-statement. This plan is for illustrative purposes only and should be used as such by any prospective purchaser. The services, systems and appliances shown have not been tested and no guarantee as to their operability or efficiency can be given.

Marie with Materniv ©2022

Let's talk

01603 660000

sales@abbotfox.co.uk

@abbotfox

EPC RATING - C

Disclaimer – In accordance with the Property Misdescriptions Act, the company abbotFox gives notice that all descriptions, references to condition, necessary permissions for use and other details are given in good faith and believed to be correct, but any purchaser should not rely on them as statements of fact, and must satisfy themselves by inspection or other means, as to their accuracy.